

VEHICLE EXHAUST EXTRACTION



ASA

Balancer and swivel arm extractors
for workplaces with stationary vehicles



FUMEX
PURE ADVANTAGE



Balancer and swivel arm extractors for workplaces with stationary vehicles

FUMEX ASA – a robust balancer extractor for removing exhaust fumes from stationary vehicles. The product is comprised of a balancer and a hose and is available in models with an articulated swivel arm length of 3200 / 4300 / 6600 / 8400 mm.

FUMEX ASA is optimised for use with the Fumex range of fans and automatic control units and is available in the sizes Ø100 / 125 / 150 mm.



ASA with an articulated swivel arm covers the needs of several workstations

FUMEX ASA with an articulated swivel arm covers several workstations. The two-way articulated joint in the centre of the arm ensures a flexible extractor throughout the entire working radius. The swivel arm is mounted on a wall or a pillar, with an estimated working radius of 6–11 metres depending on the selected swivel arm length. The bracket is fitted with a friction brake to ensure a swivel arm with great positional stability.

The exhaust extractor connects to a separate fan or an existing extraction system and is complemented with a suitable exhaust nozzle.

Hose and balancer

The standard hose is 5 metres long, crush-resistant and heat resistant up to 170°C. If a longer hose is required, it can be extended in multiples of 2.5 metres. Hoses for higher temperature are also available upon request.

The balancer is fitted with a 3.5-metre wire cable and a spring-loaded ratchet. Pull the hose down to the desired position and it stays put. Give the hose a sharp tug and it retracts to its starting position. A longer wire cable can be provided upon request.



Exhaust nozzle

See separate product sheet or scan QR code.

Pressure drop diagram

ASA Ø100 mm

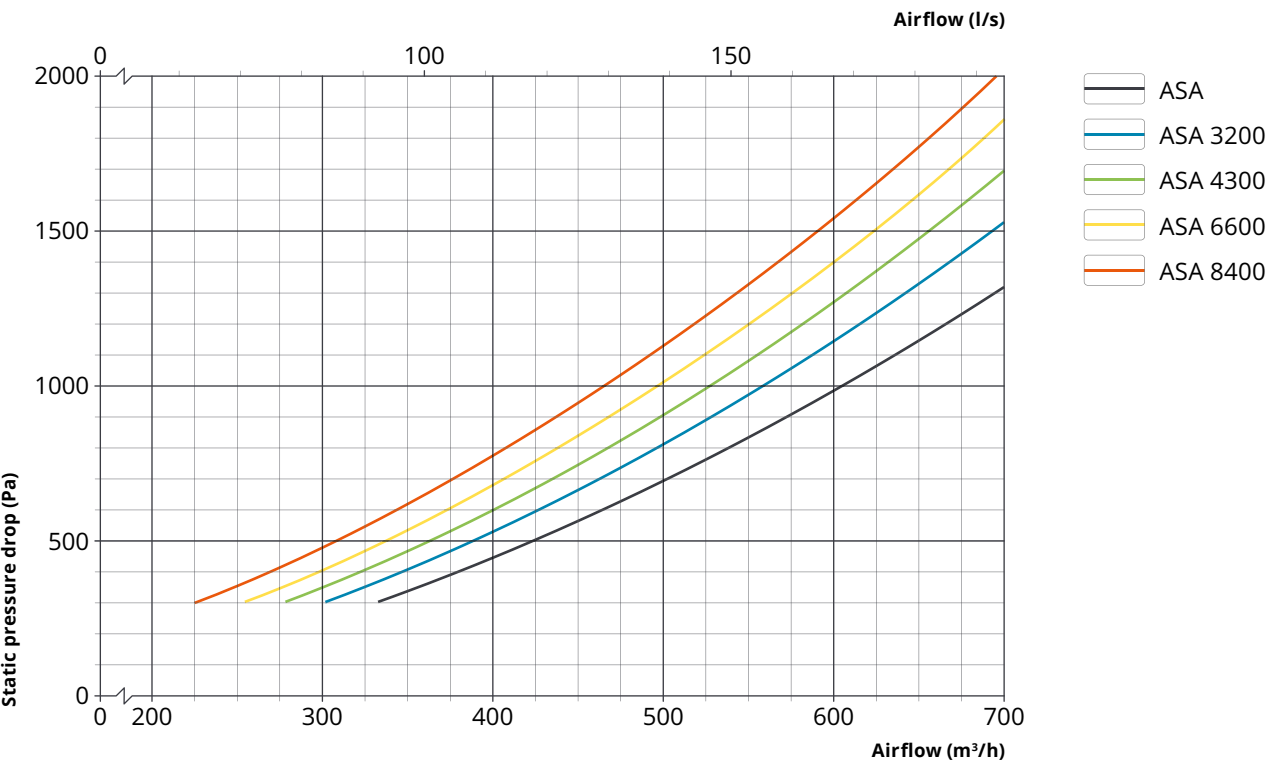

ASA Ø125 mm

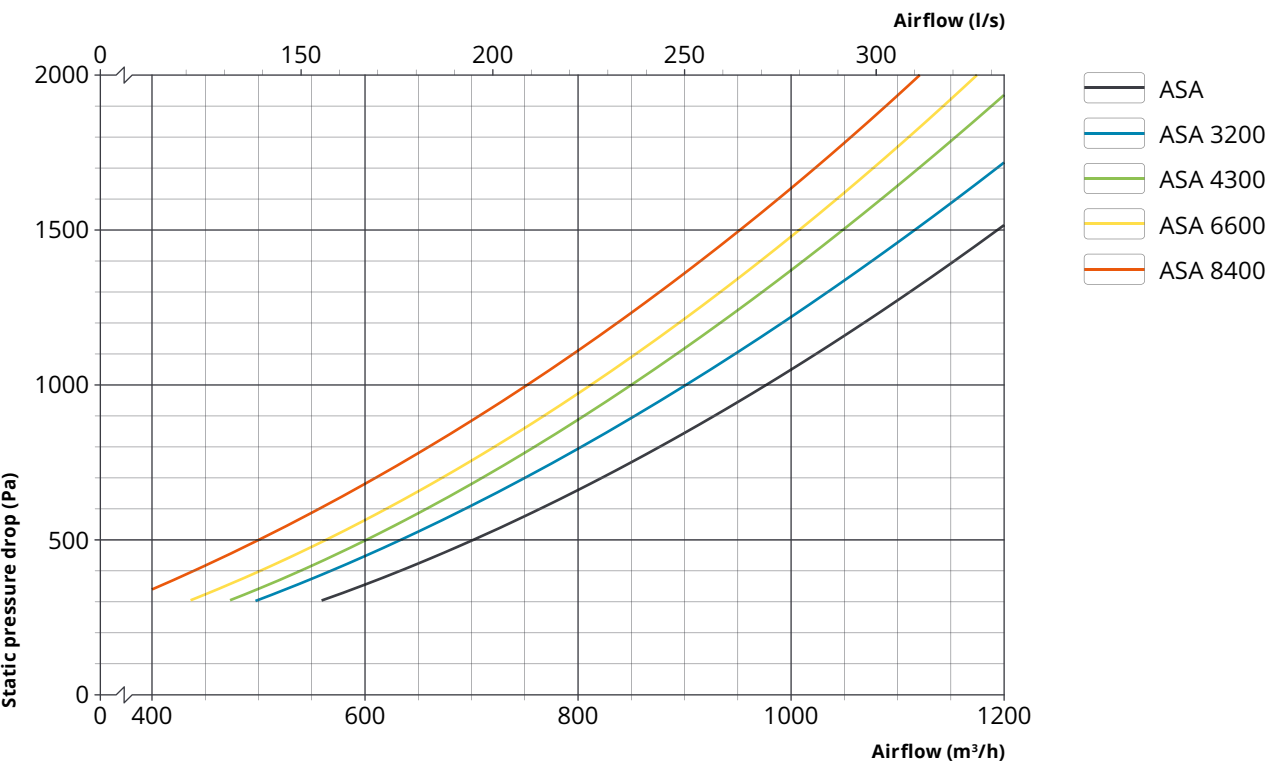

ASA Ø150 mm

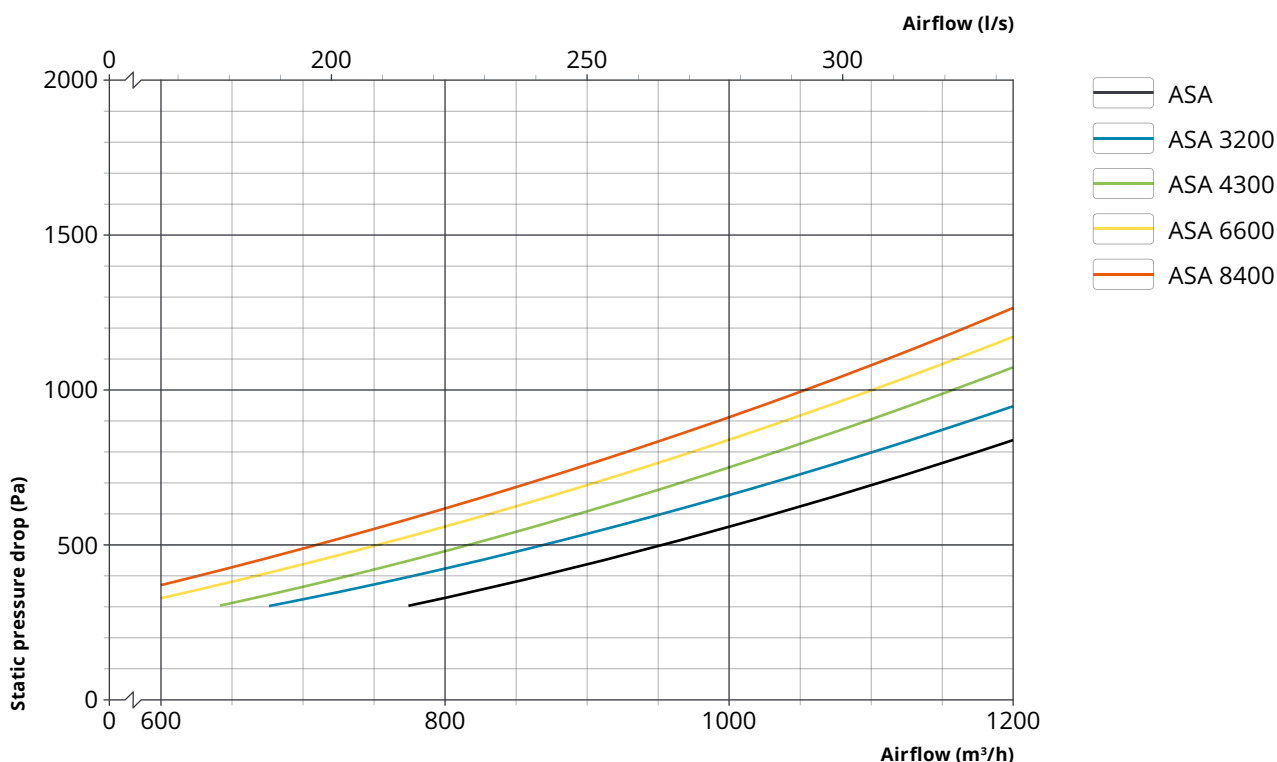

Recommended installation height

The recommended installation height for FUMEX ASA is 3-4 metres. Greater installation heights may require a longer hose and a larger balancer.

Sizing the installation

Installations are normally sized for idling vehicles. The airflow should be slightly higher than the specified exhaust fume production. The installation as a whole should be sized to handle higher loads than the minimum requirements.

Recommended airflow for extractor in vehicle workshop

The recommendations apply at low engine speeds and low engine loads.

Workshop type	m³/h	l/s
Passenger cars	400	110
Trucks	1000	280

Miscellaneous

For information on nozzles and automatic control units, see separate product sheets.

Dimensional drawing (mm)

ASA

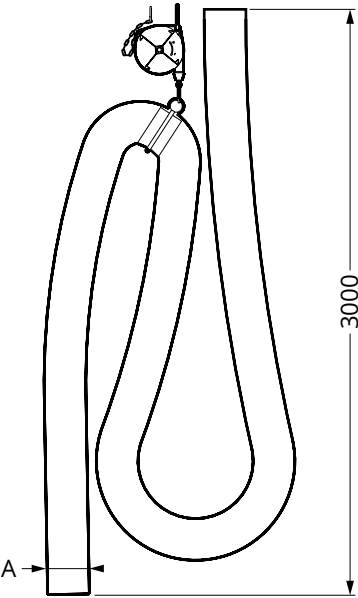

Model	Dimensions (mm)	Working radius*	Max. radius
	A		
ASA	Ø100 / 125 / 150	3000	4000

* For installation height 4 metres.

ASA 3200 / 4300

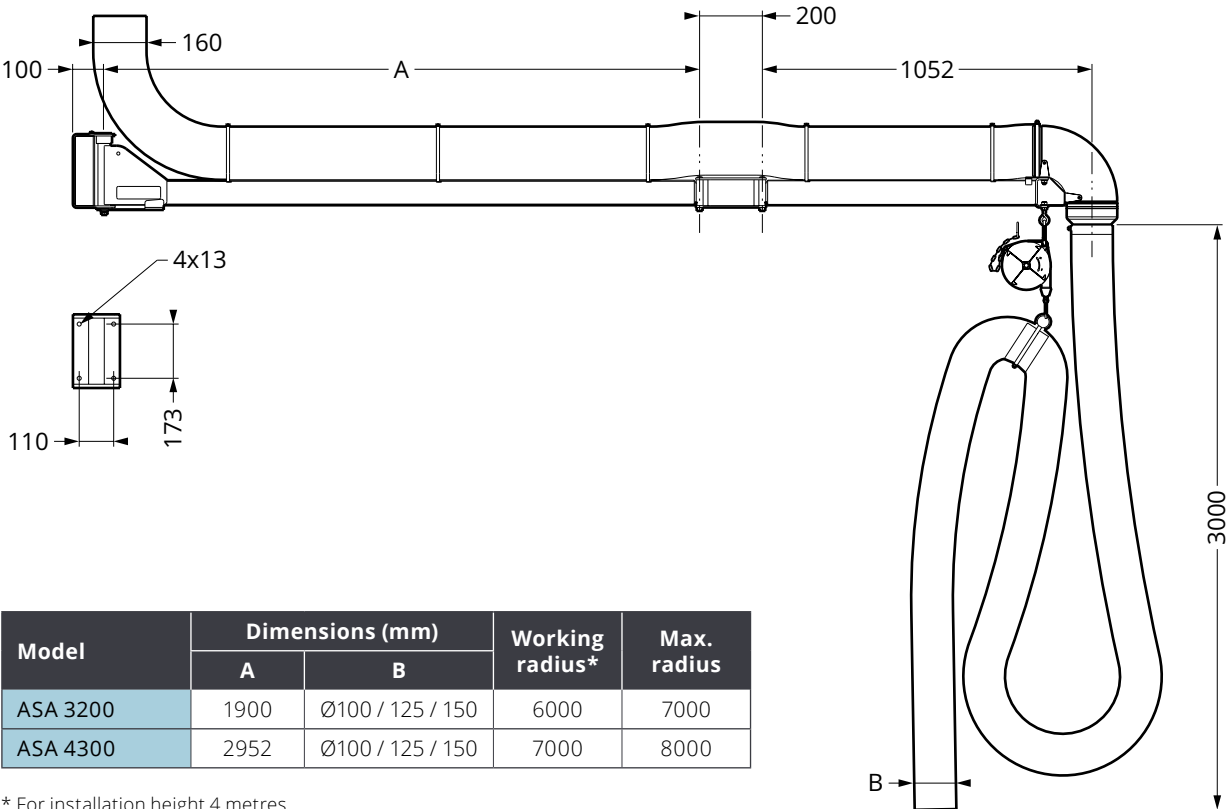

* For installation height 4 metres.

ASA 6600 / 8400

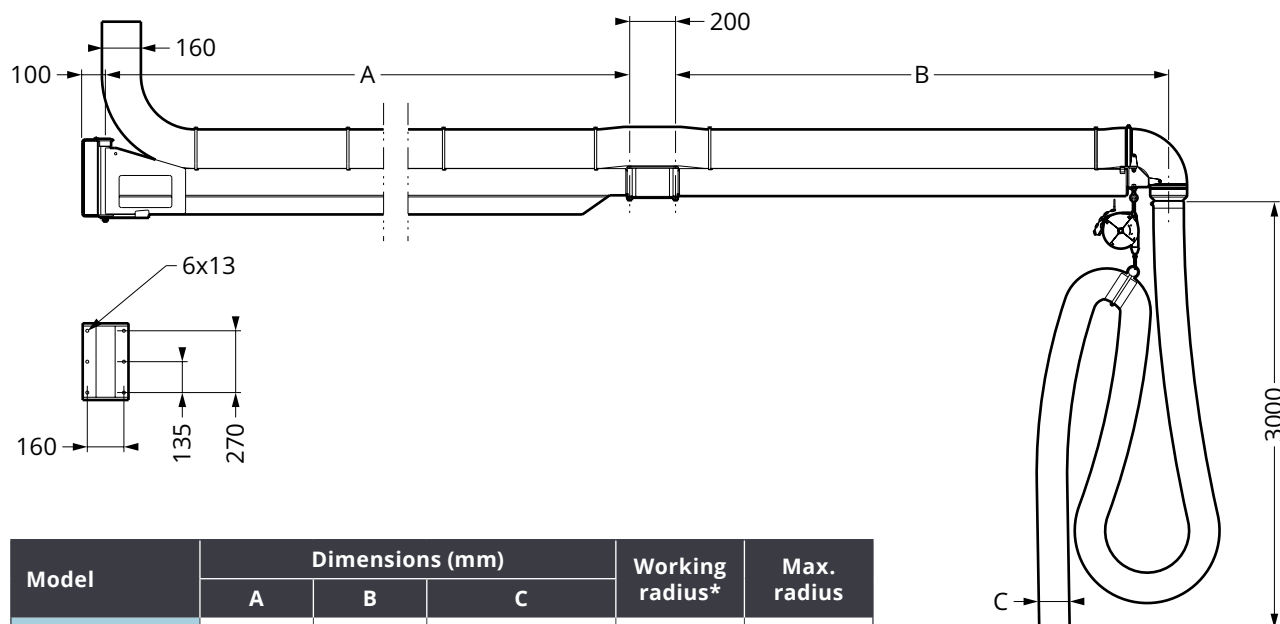

Model	Dimensions (mm)			Working radius*	Max. radius
	A	B	C		
ASA 6600	4200	2151	Ø100 / 125 / 150	9000	10000
ASA 8400	5920	2151	Ø100 / 125 / 150	11000	12000

* For installation height 4 metres.

Accessories

ASA V

Wall bracket for ASA for direct wall mounting.

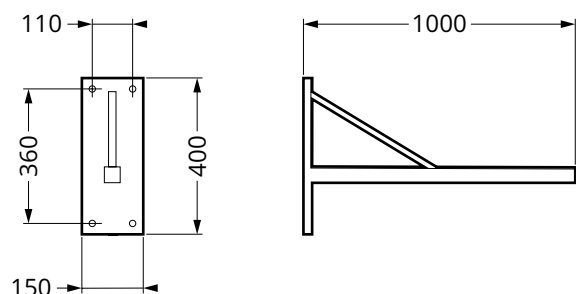

Part	Working radius*	Max. radius
ASA V	4000	5000

* For installation height 4 metres.

PTZ

Ceiling and floor bracket. 180° of rotation. Suitable for ASA 3200 / 4300.

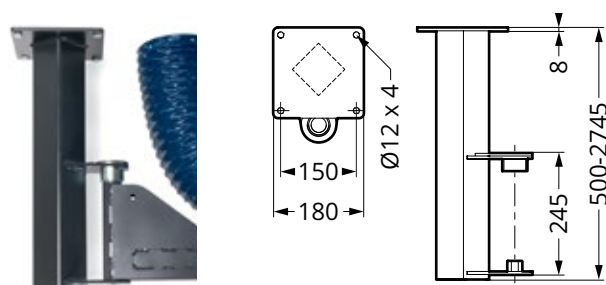

PTZ	500	1000	1500	2000	2500*
Lenght (mm)	500	1000	1500	2000	2500
Weight (kg)	7,6	12	16,6	21,2	25,7

* Floor bracket

Specifications

FORM OF DELIVERY

Supplied complete with fixtures and fittings and 5-metre hose attached to balancer for easy installation. For nozzles, fans or other hose types, see separate product sheets.

HOSE

Heat-resistant, rubberised fabric EPDM/polyester. Coiled EPDM-coated polyester. Crush-resistant (recovers shape if driven over).

BALANCER

Coil spring with ratchet, painted plastic housing.

TECHNICAL DATA

Surface finish

Sheet metal parts: Powder-coated or electro-galvanised

Hose

Properties: Flame-resistant, suitable for vehicle exhaust fumes
Temperature range:..... -30 °C to 170 °C

Balancer

Wire cable length: 3500 mm
Lifting force: 5–14 kg or 8–17 kg

Weight*

ASA: 8 kg
ASA 3200: 31 kg
ASA 4300: 38 kg
ASA 6600: 64 kg
ASA 8400: 85 kg

* Varies slightly depending on the selected hose size and type.
Stated weights are with standard Ø150 mm hose.

EXTRACTION ARMS · VEHICLE EXHAUST EXTRACTION · FANS · FILTERS · CURTAINS · CONTROLS

FUMEX